



Skyline

Book Binding Machines & Supplies

Sales • Service • Repair

Professional Service – Fast Nationwide Shipping

1-866-455-9900

www.OnlineSkyline.com CustomerService@onlineskyline.com

AP 100

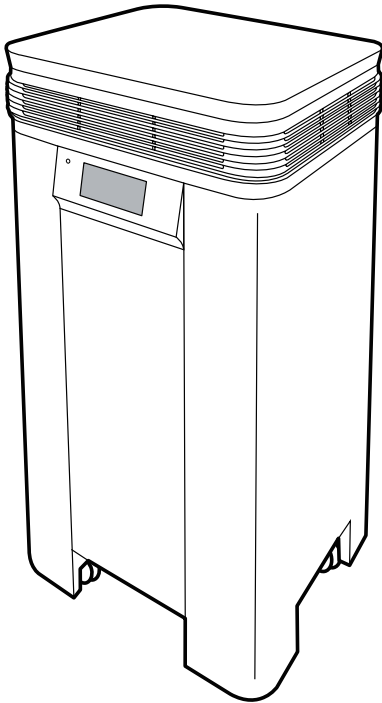



EN Please read and follow all safety rules and instructions in this manual before operating.

EN TABLE OF CONTENTS

 Caution 	Safety precautions	
	1. When Installing	44
	2. When Using	45
	3. When Cleaning	48

 Preparation 	Names of Each Part	49
	Screen Composition	51
	Installing and Preparing	
	1. Select Installation Location	54
	2. Filter Installation	55

 Use 	Using	
	1. Initial Action	58
	2. Auto Mode	60
	3. Set Fan Speed (Manual Mode)	60
	4. PlasmaWave®	61
	5. Sleep Mode	61
	6. Set Timer	62
	7. Set Wi-Fi Connection	63
	8. Set Brightness	65
	9. Set Volume	65

 Others 	How to Manage and Clean	
	1. How to Replace Filter	68
	2. How to Clean Pre-Filter	70
	3. How to Clean Fine Dust Sensor	71
	4. Cleaning exterior / cleaning interior	72

 Others 	Malfunction and Checking Measures	73
	Product Specifications	76
	Warranty	77

- Stage 1**
Fine Mesh
Ceclancel® Pre-Filter
- Stage 2**
PM2.5 Filter
- Stage 3**
Antimicrobial
Material
- Stage 4**
Active Carbon Filter
- Stage 5**
PlasmaWave®
- Stage 6**
True HEPA Filter

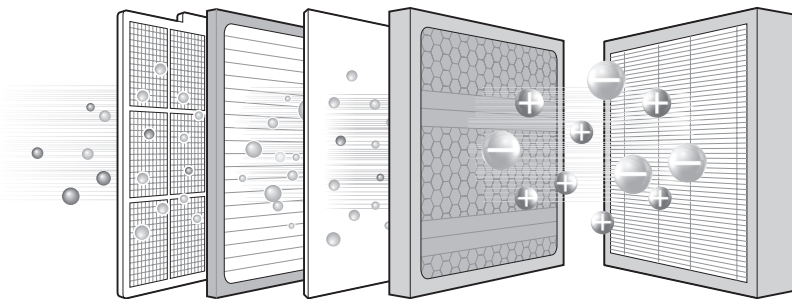

Cleansing filter section



Stage 1: Fine Mesh Ceclancel® Pre-Filter

Filters large household particles such as dust, pet hair, pollen, and lint.



Stage 2: PM2.5 Filter

Removes 99.9% of ultrafine pollutants measuring 2.5µm by mounting a PM2.5 exclusive filter.

Replacement filter section



Stage 3: Antimicrobial Material

Removes 99.9% of viruses, bacteria, and mold that cause diseases.



Stage 4: Active Carbon Filter

Removes foul smells and harmful gases indoors by absorbing odor particles from food, mold, cigarette smoke, etc. in the activated carbon micro orifice with a high-performance granular active filter.

Fixed section



Stage 5: PlasmaWave® PLASMAWAVE®

Provides clean air by removing various harmful substances from the air as well as bacteria and mold that can cause diseases.

Replacement filter section



Stage 6: True HEPA Filter

Filters not only PM2.5 ultrafine dust but also 99.97% of fine pollutants that measure 0.3µm.

FEATURES

Smart sensor

Operates automatically by comprehensively analyzing and detecting indoor air contamination levels through dust/smell/illumination level sensors.

Full-Color LCD touch screen

The 4-inch Full-Color LCD touch screen provides innovatively improved usability and convenience.

Various operation modes

Various functions, such as auto, manual, and sleep modes can be selected as desired depending on the living environment.

IAM artificial intelligence system

This allows a clean and pure living environment to be maintained at all times by responding automatically to the condition of indoor air, and can be controlled remotely even from outside when the user goes out, goes to work, or goes on a trip.

Outdoor/indoor environment information

The home screen shows local weather data, as temperature, weather conditions and Pollution level (dust PM2.5) along with the indoor air conditions.

Automatic filter management

The current condition of the filter can be seen through an exclusive APP and the LCD touch screen, and an alarm and message informs the user in advance when it is time to replace a filter.

Mobile remote control

A mobile device can be used as an indoor remote control and used to check the condition of the indoor air by connecting it to the air purifier.

Timer setup

The timer can be set to run the product between 1 and 12 hours and to power off automatically.

PACKAGE CONTENTS

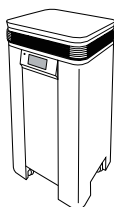

Product



Instruction manual



Product Specifications

Before operating this equipment, carefully read and follow these safety cautions and instructions to avoid damage and ensure safe use.

WARNING

Follow these instructions to reduce the risk of serious injury or death.

NOTICE

Failure to follow these safety instructions may lead to personal injury or property damage.

Installation

Do not place near flammable materials (aerosol sprays, fuel oil, gases, etc.).

This may cause an explosion or fire.

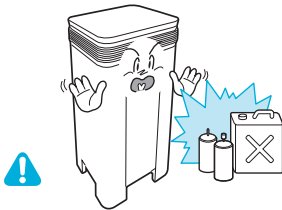

Do not install below an electrical outlet.

This may cause fire.

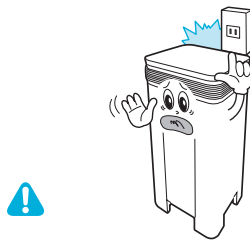

Do not place near any gas- or heat-producing appliances, such as gas appliances, heaters, and fireplaces.

This may cause the unit to become deformed, discolored, or to catch fire.

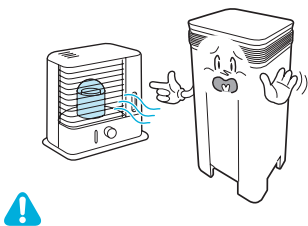

Do not install where large quantities of noxious gases are present, including carbon monoxide and gases emitted by animals.

This may cause the unit to break down.





AP 100

Installation

Do not install near electronics such as TVs, radios, or air conditioners.

Electromagnetic interference may cause the unit to malfunction.

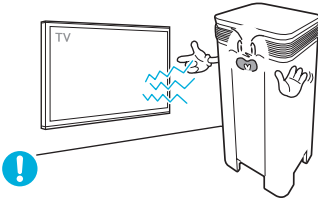

Do not place the unit facing into wind or drafts.

This may cause the sensors to fail.

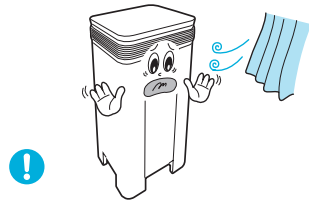

Do not install under direct sunlight, lighting fixtures with inverters, or lighting fixtures with automatic detection sensors.

This may cause the unit's sensors to malfunction.

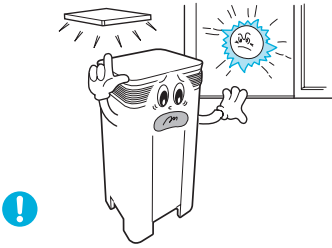

Do not use around mist or fumes from industrial oil or around large quantities of metallic dust.

This may result in fire or may cause product failure.

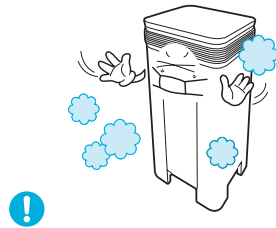

Do not install in confined spaces or on slanted or uneven surfaces.

This may cause product failure or deformation.

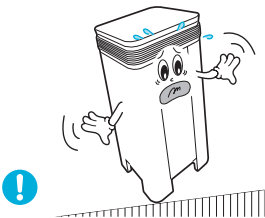

Do not install in any sort of transport (motor vehicles, boats, ships, etc.).

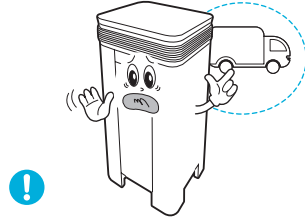



Operation

Do not use in places that are very humid or moist or where the unit may get wet, such as bathrooms.

This may result in fire or electric shock.

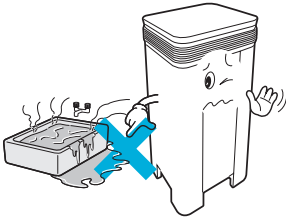

Unplug the power cord when not in use for long periods.

Leaving it plugged in could cause the insulation to deteriorate, posing a risk of short circuit and fire.

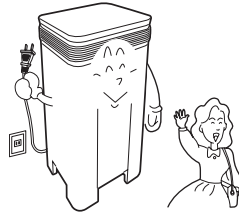

Do not plug other appliances into the same outlet. Provide an exclusive outlet for this unit.

Also, do not arbitrarily extend the power cord. Risk of electric shock or fire may result from plugging several appliances into one outlet, modifying the power cord, or using an extension cord.

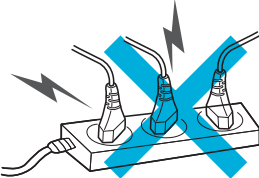

Do not pull on the power cord when unplugging the unit.

This may cause electric shock or fire.

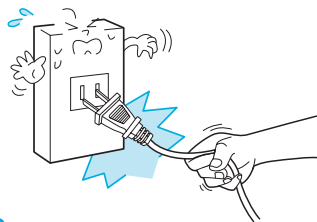

Do not touch the plug with wet hands.

This may result in electric shock.

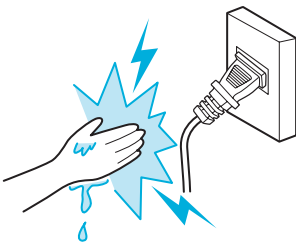

Do not damage the power cord by forcefully bending, pulling, twisting, bundling, or pinching it, or by placing heavy objects on it.

Damaging the power cord could lead to a short circuit, resulting in electric shock or fire.

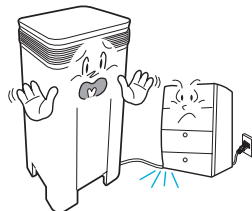



AP 100

Operation

Do not unplug or move the unit while it is running.

This may cause product failure or fire.

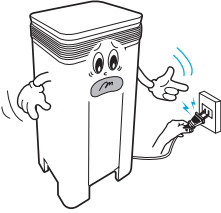

Make sure the filters have been inserted before running the unit.

Running it without filters shortens the product's service life and may cause electric shock or injury.

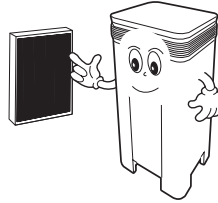

Do not touch the interior of the unit with wet hands.

The high voltage may cause electric shock.



Do not insert foreign objects into the vents, such as pins, rods, and coins.

Make especially sure that children follow safety rules around the unit. Unsafe behavior may result in product failure or injury from burns or electric shocks.

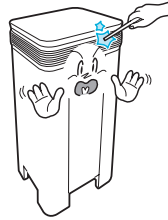

If the unit becomes submerged in water, unplug it and contact the service center.

If you attempt to dry and operate the unit after it has been submerged, this could result in product failure, electric shock, fire, or injury.

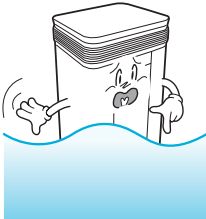

When cooking foods with strong odors, reduce use of the unit as much as possible.

The filters may become permeated with the cooking odors, possibly affecting the filters' performance and service life.

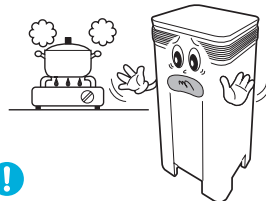



Operation

Do not step on or place heavy objects on top of the unit.

This could result in personal injury, or may cause product failure or deformation.



Do not use in places with extremely high or low temperatures.

This product is for indoor use (5-30°C). Using it outside this temperature range may cause deformation, discoloration, or shortened filter life.

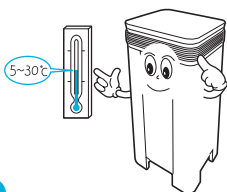

If the product emits unusual noises, smells, or smoke, unplug the power cord immediately and contact the IDEAL service center.

Such occurrences may lead to electric shock or fire.

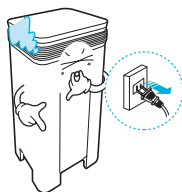

Never disassemble, repair or modify this product yourself.

This may cause product failure, electric shock, or fire. If repairs are needed, contact the service center.

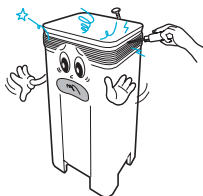

Do not subject the product to strong blows or physical shocks.

This may lead to product failure.



Do not allow intake or outlet vents to become blocked, for instance by furniture, laundry, curtains, or other objects.

Such blockage may lead to increased internal temperatures, causing product deformation.

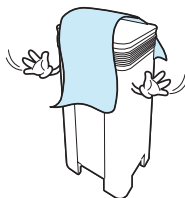



AP 100

Operation

Do not tie up or bundle the power cord when operating the unit.

This may cause electric shock or fire.

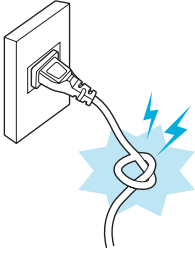

Do not use for specialized purposes or sites, such as places devoted to animals and plants, precision instruments, or art conservation.



Cleaning

Do not use flammable sprays or liquid detergents.

This may cause product failure, electric shock or fire.

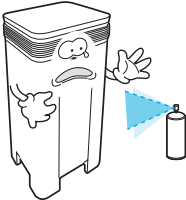

Do not let water run over the Unit.

This may lead to product failure, electric shock or fire.

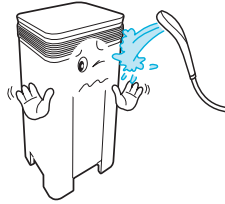

Do not allow children to clean or maintain the unit by themselves.

Adult supervision is absolutely necessary.

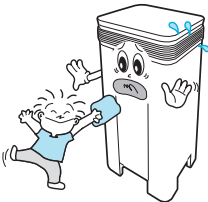

Before cleaning or performing maintenance, unplug the power cord and be sure the fan has stopped.

Not doing so could result in electric shock or injury.





Name of Each Part

| Front |

Top cover

Air vent (4 directions)

Light detecting sensor

Full Color LCD Touch screen

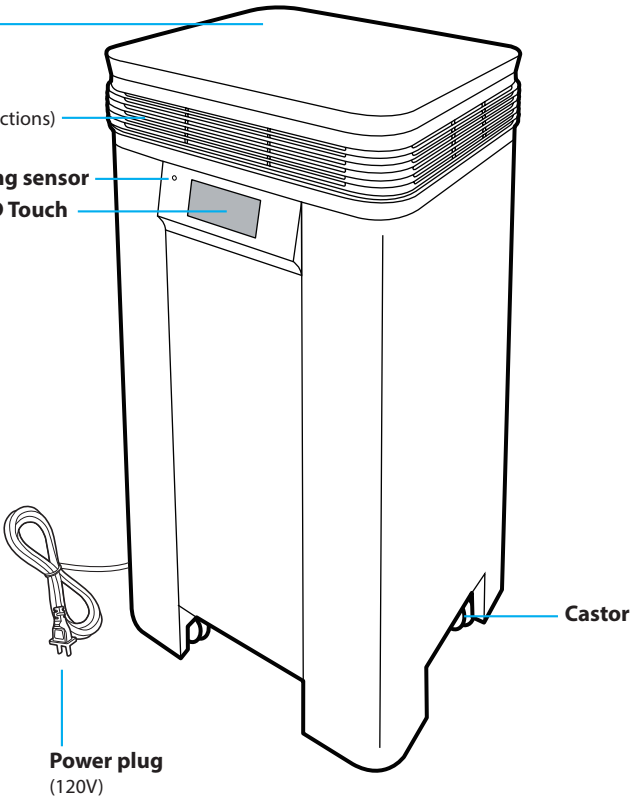

Castor

Power plug
(120V)



Screen Composition

| Main (Home) Screen |

The color of the main screen will change depending on the condition of the indoor air.

Brown: poor / **Green:** fair / **Blue:** good

Temperature condition display

Displays indoor temperature along with the main screen color.

Current exterior environment information

Displays current exterior environment information including weather, temperature, and dust level.

Wi-Fi

Indicates Wi-Fi connectivity status.

Contamination level information

Displays indoor contamination level along with the main screen color.

PlasmaWave®

Displays when PlasmaWave is in operation.

Power

The power to the air purifier can be turned off.

Menu

Selecting the menu will display 6 menu items at the bottom of the screen.



see page 52

Current fine dust

Displays current fine dust level (PM 2.5).

Sleep mode

Sleep mode can be setup.

Fan speed condition

Displays wind speed currently in operation.

Current temperature

Displays current indoor temperature.

Current weather

Displays current exterior weather.

Power off reservation time

Displays power off reservation time (8H ON).

Auto mode

Automatically sets wind speed depending on the condition of indoor air.

Manual mode

The user can set the desired mode.

| Menu Screen |

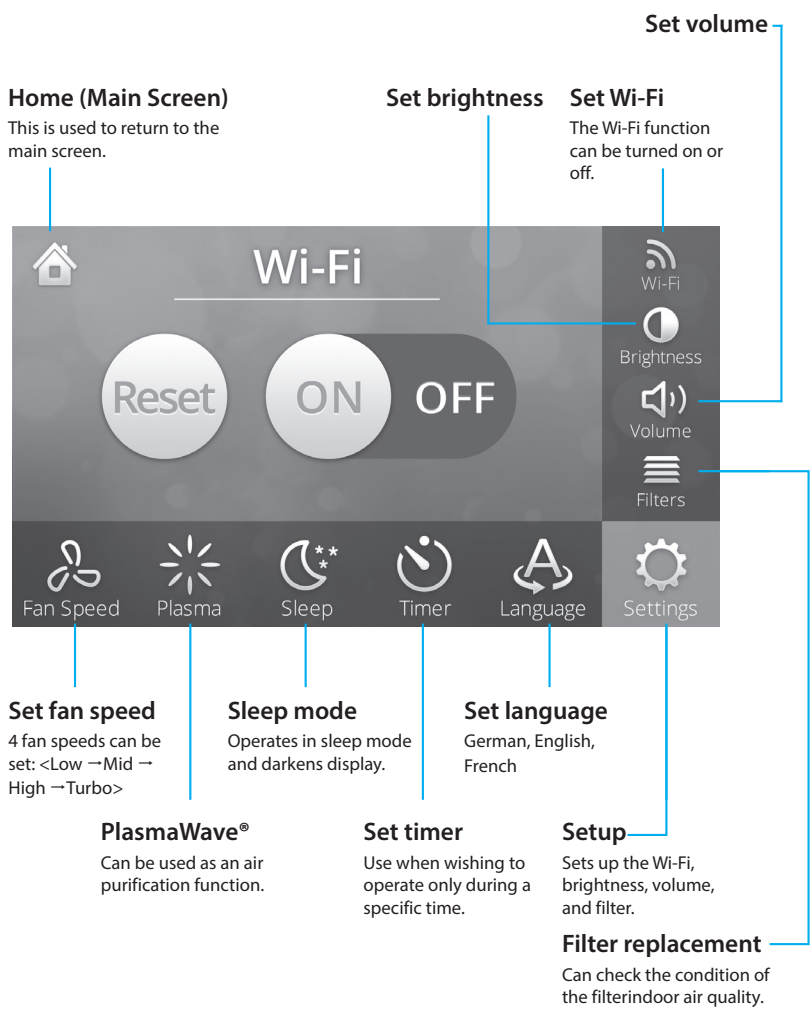



| Alert/Verification Window |

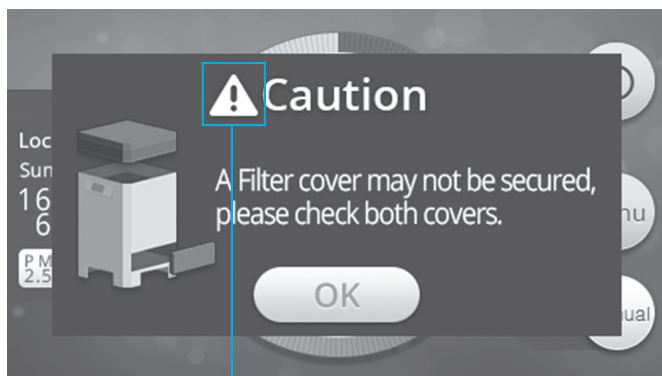

Alert pop-up window

Appears when the filter replacement time is notified, when the filter cover is opened, and when the filter cover is closed



Verification pop-up window

Appears when a problem occurs with the product, when asking for verification for Wi-Fi initialization, and when power is turned off during operation.



AP 100

Installation and set-up

1. Choosing a location

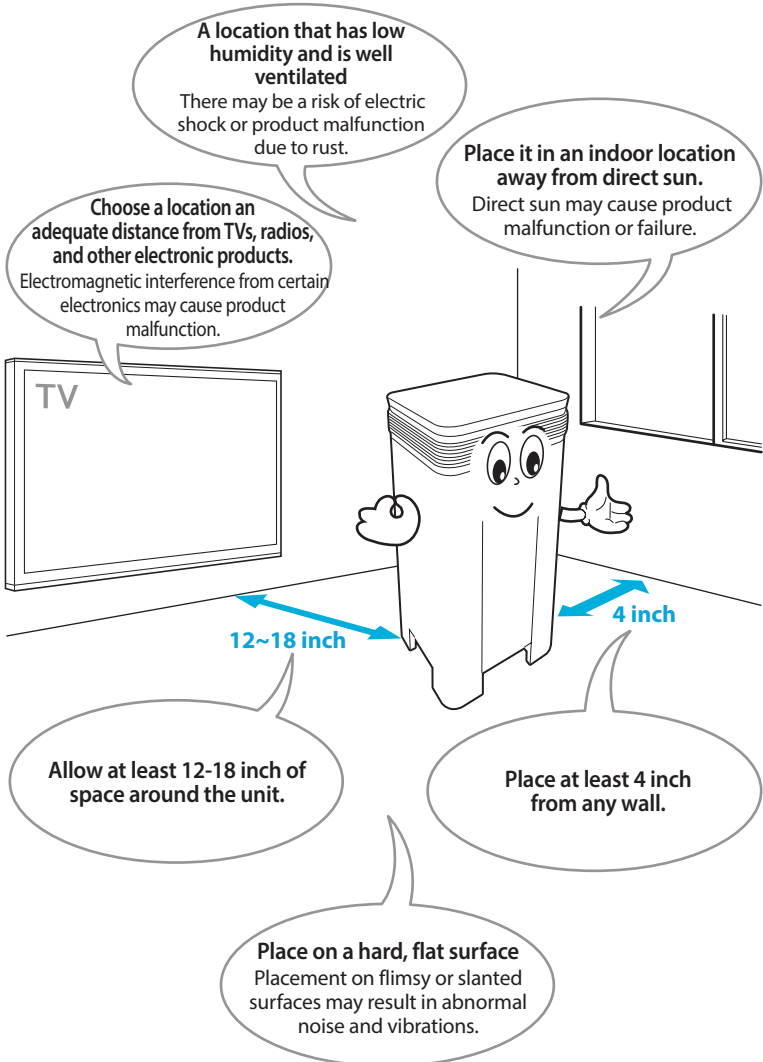



2. Filter Installation

All filters are assembled and packaged before being shipped out of the factory. The packaging of filters must be removed before use.

✗ Failure to remove the packaging before operating the product may result in malfunction.

Filters must be replaced only while the power is turned off.

■ 1 Fine Mesh Cleancel® Pre-Filter, 2 Antimicrobial PM2.5 Filter, 3 Activated Carbon Filter installation

- ① Push the two buttons on the filter cover at the bottom of the product towards the middle and take the cover off by pulling it towards you.

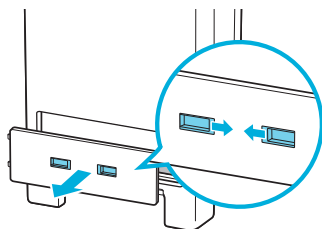

- ② Pull the new filter from the vinyl packaging.

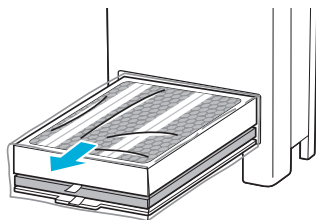

- ③ Remove the vinyl packaging from the new filters.

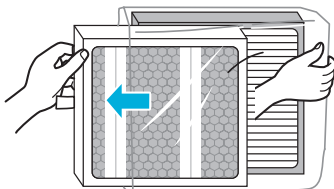

Caution

► Failure to remove the vinyl packaging before use may result in abnormal noise, product deformation or fire caused by overheating of the motor.

**AP 100**

- ④ **1** Fine Mesh Cleancel® Pre-Filter
2 Antimicrobial PM2.5 Filter **3** Active Carbon Filter. Push the filters in this order to the very back of the product.

3 Active Carbon Filter

2 Antimicrobial PM2.5 Filter

1 Fine Mesh Cleancel® Pre-Filter

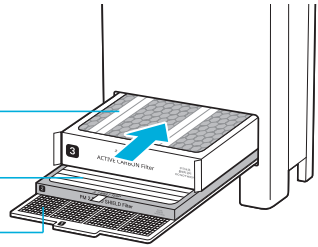

Caution

- ▶ Please make sure that the pre-filter is not flipped upside down before inserting. Dust filtered during operation will fall to the bottom of the air purifier during filter changes if the pre-filter is flipped upside down.

- ⑤ Push the two buttons on the filter cover towards the middle to attach it to the product.

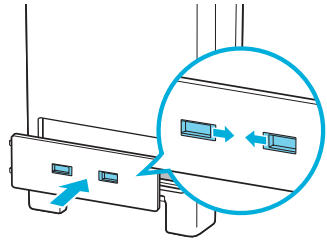



■ 4 True HEPA Filter installation

- ① Press the release buttons on either side of the top cover and lift the cover off.

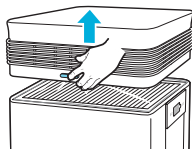

- ② Pull the new filter out and remove its vinyl packaging.

- Failure to remove the vinyl packaging before use may result in abnormal noise, product deformation or fire caused by overheating of the motor.

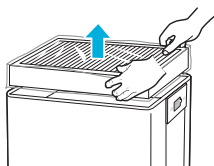

- ③ Insert the new 4 True HEPA Filter.

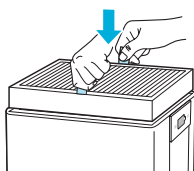

- ④ Press the release buttons on either side of the top cover and attach it to the product.

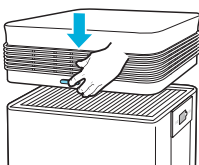

- ⑤ Filter cleaning and replacement cycle.

Filter type	Cleaning cycle	Replacement cycle
1 Fine Mesh Cleancel® Pre-Filter	2 times per month	Semi-permanent
2 Antimicrobial PM2.5 Filter	-	12 months
3 Active Carbon Filter	-	12 months
4 True HEPA Filter	-	12 months

※ There may be a difference in the filter replacement cycle depending on usage environment.

Filter purchase inquiries: www.ideal-health.de



Reference

▶ Please refer to pages 68~69 for details on how to replace filters



AP 100

How to Use

1. Initial action

① Insert the power plug into a power outlet.

- The Display Panel lights will turn on and then off.

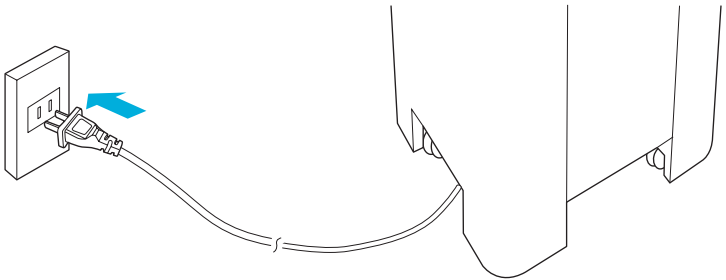

② Press the "Power" button.

- A start video will play along with music as the power is turned on.

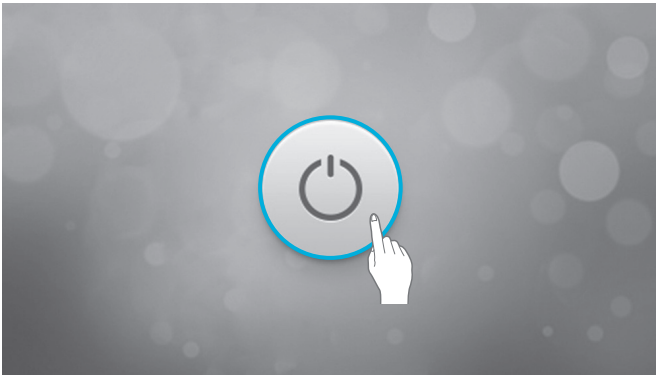

Reference

- For the first 4 minutes, the product's smart sensor will measure the surrounding air cleanliness level.



③ "Auto", "PLASMAWAVE", "Regional Info", etc. will be displayed and the product will run.

- The fan speed will be set automatically depending on the indoor air contamination level and PlasmaWave® will run to remove harmful substances in the air.
- The color of the main button will change to brown (poor), green (fair), or blue (good) depending on the condition of the indoor air.



■ To turn the power off

Press the "Power" button.

- When you press the "Power" button, the power goes off.

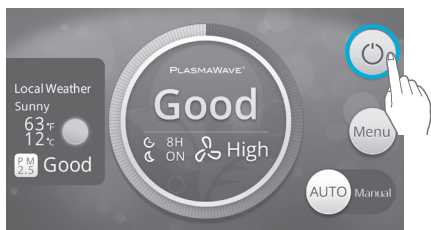

AP 100

2. Auto Mode

Runs automatically by detecting indoor air contamination level.

Select "Auto".

- The product will run with "PlasmaWave®" displayed.
- The fan speed will be adjusted automatically depending on indoor air contamination level and PlasmaWave® will run to remove harmful substances from the air.

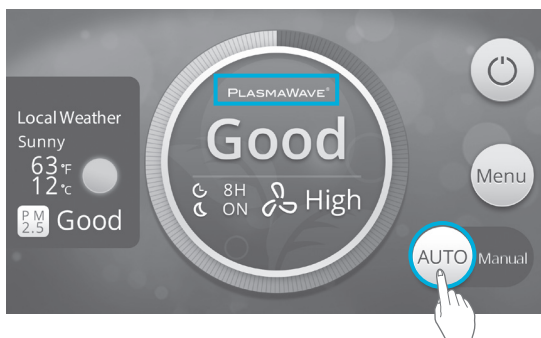

Reference

- ▶ Once the indoor air is cleaned, the wind speed will be set to run continuously as "low".
- ▶ The electric noise that emanates during operation is the normal sound produced by PlasmaWave and does not signify a malfunction.

3. Fan speed setup (manual mode)

Runs automatically by detecting indoor air contamination level.

- ① Select "Menu".
- ② Select "Fan speed setup" and select the desired "Fan speed".

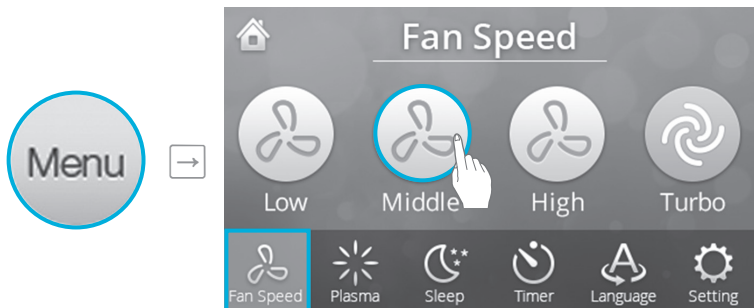



4. PlasmaWave®

This air purification function removes harmful substances from the air.

- ① Select "Menu".
- ② Select "PlasmaWave®" and then select "ON".
 - PlasmaWave® will begin running.

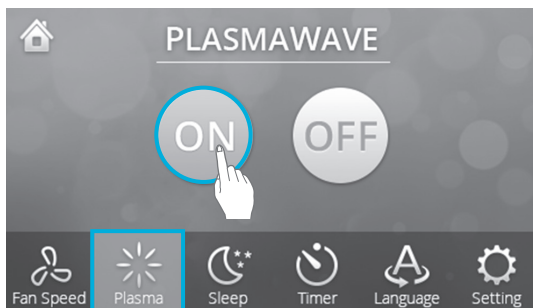

5. Sleep Mode

- ① Select "Menu".
- ② Select "Sleep" and then select "ON".
 - Sleep mode will run and the display will darken.

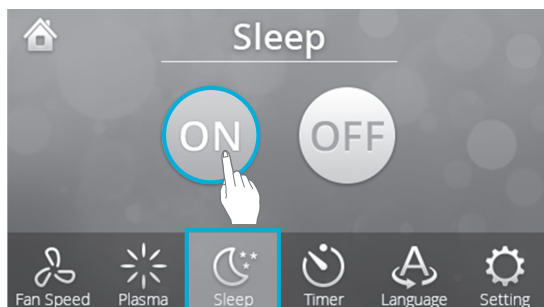

Reference

- ▶ If the wind speed is changed by pressing the "Fan speed" button, sleep mode will be cancelled and the product will return to manual mode.
- ▶ Selecting sleep mode will automatically turn off PlasmaWave®.



AP 100

6. Timer Setup

Select this if you wish to run the product during a specified time.

- ① Select "Menu".
- ② Select "Power off reservation" and then select "-" or "+".
 - You can set up to "12 hours".
 - Selecting "-" will decrease by 1 hour, while selecting "+" will increase by 1 hour.

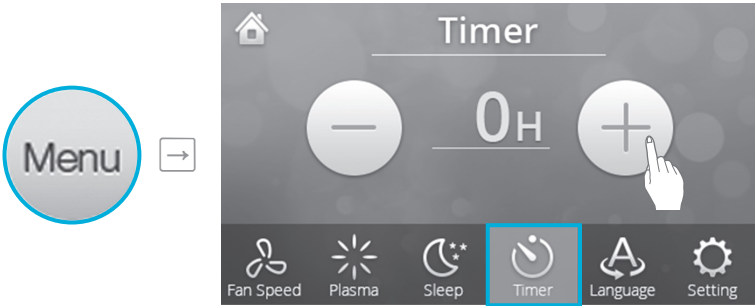

Language

The LCD language can be set to English, German and French.

1. Select the Menu Screen.
2. Select the Language Screen.
3. Select which language to displayed.





7. Set Wi-Fi connection

Things to know before connecting to Wi-Fi

- Prepare the wireless router to be connected to the air purifier.
- An error will occur during setup if two or more wireless routers are connected.
- If several air purifiers are to be set up, do it individually one by one.
- The air purifier, wireless router, and mobile device must be within 32 ft in order to be connected and setup.
- Before registering, check the Wi-Fi name and password of the location you wish to install in.

■ Initial setup.

When connecting for the first time after being shipped from the factory.

- ① Select "Power" and then select "Menu".

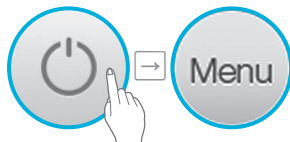

- ② Select "Setup", select "Wi-Fi", select "ON".

- The "Wi-Fi" icon will flicker.

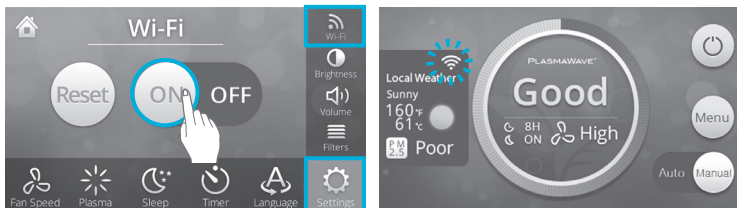

- ③ To install the IDEAL air app, search for "IDEAL air" in the App Store or in the Google Play Store.

- ④ Run the downloaded exclusive APP and follow the app's instructions to register the wireless router.

- Enter the name and password of the Wi-Fi you wish to use.



Reference

▶ Please check the Wi-Fi name and password in advance.

- ⑤ Check the Wi-Fi connection.

- Wi-Fi is connected once the "Wi-Fi" icon stops blinking.
- Wi-Fi icon can keep blinking up to for 3 minutes depends on local weather data reception status even wifi connection is done.



AP 100

■ Re-setup

- If you wish to use it in an area that is different from the Wi-Fi area that was initially setup.
- If you wish to delete the mobile device that was being used and register a new mobile device.

- ① Select "Menu" and then select "Setup".



- ② Select "Wi-Fi" and then select "Reset".

- A pop-up window will appear that asks to confirm Wi-Fi initialization.



- ③ Select "Yes".

- Wi-Fi setup will be initialized.



- ④ To install the IDEAL air app, search for "IDEAL air" in the App Store or in the Google Play Store.

- ⑤ Run the downloaded exclusive APP and follow the app's instructions to register the wireless router.

- Enter the name and password of the Wi-Fi you wish to use.



Reference

▶ Please check the Wi-Fi name and password in advance.

- ⑥ Check the Wi-Fi connection.

- Wi-Fi is connected once the "Wi-Fi" icon stops blinking.
- Wi-Fi icon can keep blinking up to for 3 minutes depends on local weather data reception status even wifi connection is done.



8. Set Brightness

- ① Select "Menu" and then select "Setup".
- ② Select "Brightness" and then select "-" or "+".
 - Selecting "-" will gradually darken the screen, while selecting "+" will gradually brighten the screen.

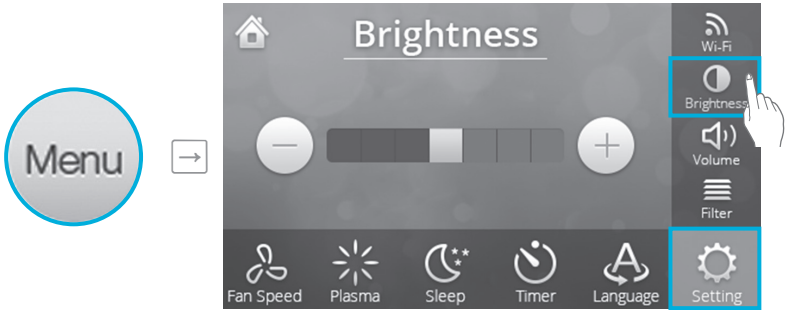

9. Set Volume

- ① Select "Menu" and then select "Setup".
- ② Select "Volume" and then select "-" or "+".
 - The volume can be set to 6 levels
 - Selecting "-" gradually decreases the volume, while selecting "+" gradually increases the volume

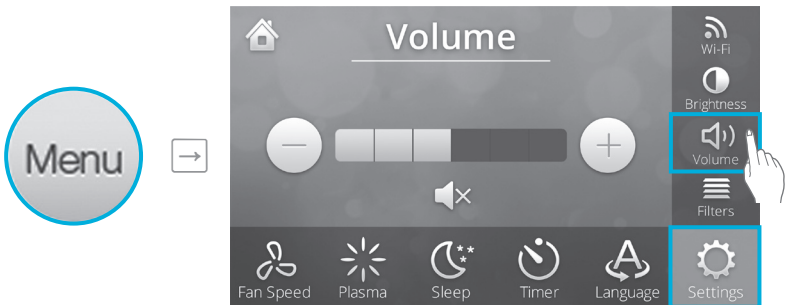



How to Manage and Clean

1. How to Replace Filter

■ Checking the filter

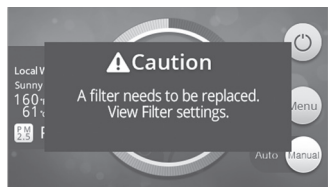
- When it appears, touch the pop-up window that alerts you it is time to replace the filter.



 **Reference**

- ▶ A pop-up window will appear when it is time to replace a filter.
- ▶ The pop-up window will disappear if you touch anywhere on the screen other than the pop-up window.

- You can check each filter's extent of use by going to the filter setup screen.

- Each block on the scale in the filter setup screen represents 1 month, and filters whose scale is empty must be replaced.

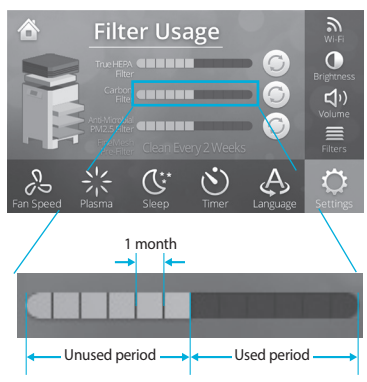

■ Filter Setup

- Close the filter cover once the filter is replaced. (Please refer to pages 68~69 for how to replace filter)

 **Caution**

- ▶ A pop-up window will appear and an alert tone will ring if the filter cover is not closed properly.

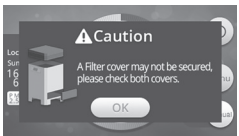



- ② Select "YES" if a pop-window appears asking to reset a filter.

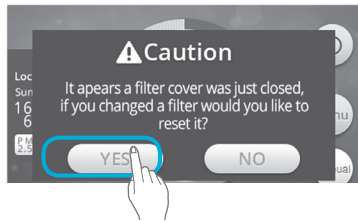

- ③ Select "Reset" for filters that have been replaced.



- ④ Select "Yes" if a pop-up window appears asking to confirm initialization.

- The filter setup will be initialized.

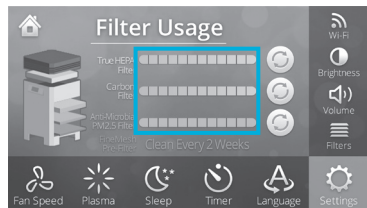
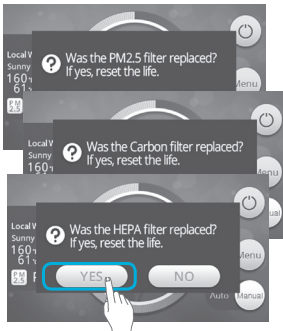

- ⑤ Filter cleaning and replacement cycle.

Filter type	Cleaning cycle	Replacement cycle
1 Fine Mesh Cleancel® Pre-Filter	2 times per month	Semi-permanent
2 Antimicrobial PM2.5 Filter	-	12 months
3 Active Carbon filter	-	12 months
4 True HEPA filter	-	12 months

There may be a difference in the filter replacement cycle depending on usage environment.

Filter purchase inquiries: www.ideal-health.de

AP 100

■ **1 Fine Mesh Cleancel® Pre-Filter, 2 Antimicrobial PM2.5 Filter, 3 Active Carbon Filter replacement**

- ① Push the two buttons on the filter cover at the bottom of the product towards the middle and take the cover off by pulling it towards you.

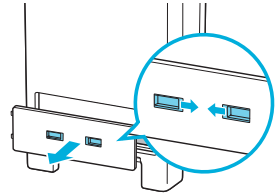

- ② Hold the grips on either side of the **3 Active carbon filter** and pull it out. Hold the grips of the **2 Antimicrobial PM2.5 filter** and pull it out. Hold the grip on the front of **1 Fine Mesh Cleancel® Pre-filter** and pull it out.

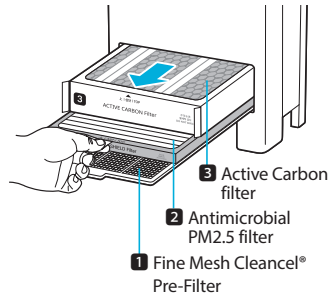

- ③ **1 Fine Mesh Cleancel® Pre-Filter 2 Antimicrobial PM2.5 filter 3 Activated carbon filter.** Push the filters in this order to the very back of the product.

 **Caution** ▶ Please make sure that the pre-filter is not flipped upside down before inserting.

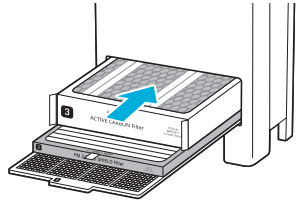

- ④ Push the two buttons on the filter cover towards the middle to attach it to the product.

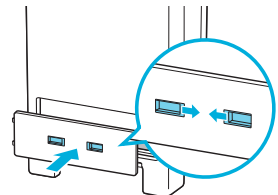

 **Caution** ▶ Only genuine IDEAL filters must be used.



■ 4 True HEPA filter replacement

- ① Press the release buttons on either side of the top cover and lift the cover off.

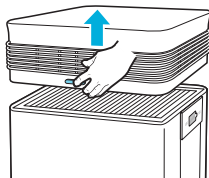

- ② Hold the grips on either side and pull the filter out.

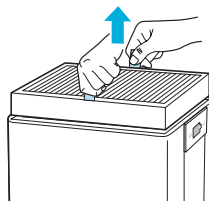

- ③ Insert the new 4 True HEPA filter.

- Make sure to remove the vinyl packaging from the new filter set before using.
- Failure to remove the vinyl packaging before use may result in abnormal noise, product deformation or fire caused by overheating of the motor.

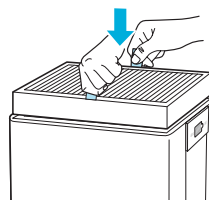

- ④ Press the release buttons on either side of the top cover and attach it to the product.

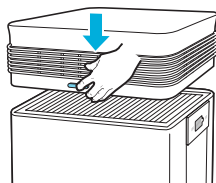

Caution

- ▶ A pop-up window will appear and an alert tone will ring if the filter cover is opened.

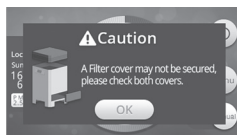



AP 100

2. How to Clean Pre-Filter

The filter cleaning time may differ depending on the surrounding contamination levels.

Clean using a vacuum cleaner or a soft brush, and use a neutral detergent to clean if it is heavily contaminated.

- With the exception of water, do not clean using volatile substances, alcohol, acetone, etc.
- Cleaning around 2 times per month will allow you to use a filter semi-permanently.

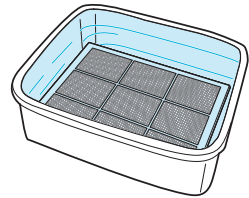
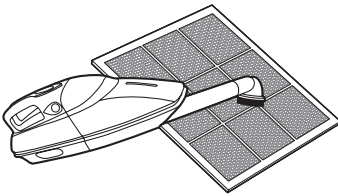
**Caution**

- ▶ Make sure to unplug and allow the product to cool down completely before cleaning.
- ▶ Do not use benzene, alcohol, or other volatile detergents as they may cause damage or discoloration.
- ▶ The pre-filter can be cleaned and reused.
- ▶ Do not use volatile liquids such as water that is hotter than 40°C or thinners.
- ▶ Filters must be replaced if the contamination is severe to the point that cleaning is not possible.
- ▶ Filters must be dried completely in a place where air flows well because filters that are not dried completely can result in them giving off a bad smell.



3. How to Clean Fine Dust Sensor

The dust sensor detects the contamination level of dust, so it is recommended to clean the sensor once every two months for the air purifier to function optimally. Please clean the sensor more often if the product is used in a location where there is a greater amount of dust.

① **Open the dust sensor cover.**

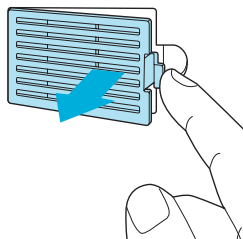

② **Clean the dust sensor lens and the inlet with a damp cotton swab.**

- With the exception of water, do not clean the sensor area with volatile substances, alcohol, acetone, etc.

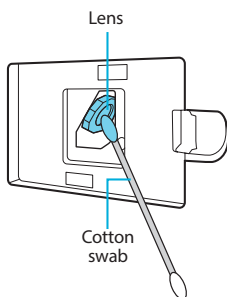

③ **Wipe the moisture off with a dry cotton swab.**

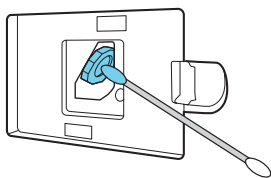

④ **Close the dust sensor cover.**

- The dust sensor cover can be cleaned with a vacuum cleaner.

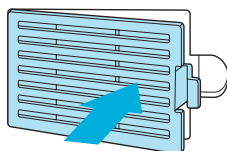



AP 100

4. Cleaning the exterior / Cleaning the interior

■ Exterior

Wipe the product with a soft cloth made wet with water mixed in with a neutral detergent, and then wipe it with a dry cloth.

- Clean the air vent on the top cover with a vacuum cleaner or a duster around 1~2 times per month.

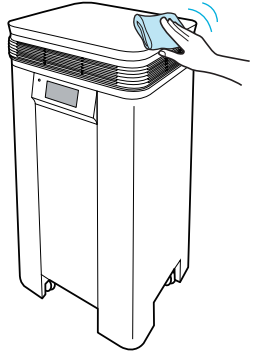

■ Interior

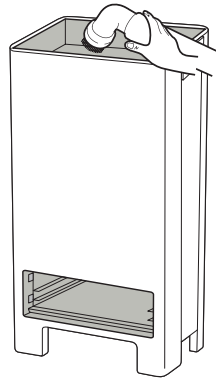

Open the top cover and clean with a vacuum cleaner.

- Clean the interior with a vacuum cleaner or a duster around 1~2 times per month.





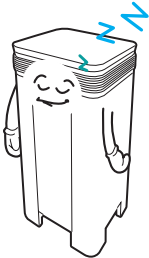

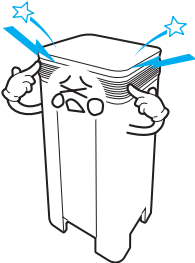

Troubleshooting

Problem	Check / Measures
<p data-bbox="65 431 342 491">It does not turn on at all</p> 	<ul data-bbox="373 471 904 759" style="list-style-type: none"><li data-bbox="373 471 904 628">▶ Is the power cord securely attached to the socket on the back of the unit? Check both ends of the power cord to make sure it is plugged in and the power connections are secure.<li data-bbox="373 664 904 759">▶ Is there a power outage? Check to see if other lights and electrical equipment are working and try again.
<p data-bbox="65 847 342 906">It doesn't work in Automatic mode.</p> 	<ul data-bbox="373 861 904 1214" style="list-style-type: none"><li data-bbox="373 861 904 987">▶ Is the power cord securely attached to the socket on the back of the unit? Try turning it on again after detaching and reattaching the power cord.<li data-bbox="373 1023 904 1118">▶ Has Automatic mode been selected? Press the Mode button until Automatic mode is selected.<li data-bbox="373 1154 904 1214">▶ Is the sensor blocked or clogged? Clear the sensor using a vacuum cleaner.
<p data-bbox="65 1277 342 1336">It vibrates and makes a lot of noise.</p> 	<ul data-bbox="373 1438 904 1499" style="list-style-type: none"><li data-bbox="373 1438 904 1499">▶ Is it running on a slanted surface? Move the unit to a hard, flat area of the floor.



Problem	Check / Measures
<p>The power plug and power outlet are hot.</p> 	<ul style="list-style-type: none"> ▶ Is the power plug plugged in correctly? Plug in the power plug correctly.
<p>There is a strange smell.</p> 	<ul style="list-style-type: none"> ▶ Are you using it in a place with large amount of smoke, dust, or smell? The effects of air purifiers can be reduced if used in a place with large amount of smoke or smell. Please open a window and ventilate the room before using.
<p>The wind speed is weak. The air does not get purified.</p> 	<ul style="list-style-type: none"> ▶ Does the filter replacement alert pop-up window appear? A pop-up window will appear that informs you it is time to replace the filter from 1 month before the filter replacement time.

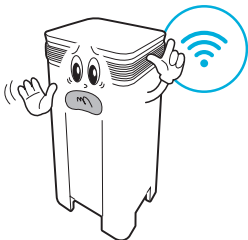

Problem	Check / Measures
<p data-bbox="64 431 304 462">The display is dark.</p> 	<ul style="list-style-type: none"><li data-bbox="373 584 902 709">▶ Is there any debris on the illumination level sensor window? Remove the debris from the illumination level sensor.<li data-bbox="373 745 902 870">▶ Is it in sleep mode? If the indoor lighting becomes dark, the product will be automatically set to sleep mode and the display area will darken.
<p data-bbox="64 1071 293 1130">The Wi-Fi function does not work.</p> 	<ul style="list-style-type: none"><li data-bbox="373 1336 643 1395">▶ Is the Wi-Fi turned off? Turn the Wi-Fi on.



AP 100

Product Specifications

Model Name	AP 100
Power Voltage	AC 120V, 60 Hz
Power Rate	200 W
Siutable for room sizes up to	697,5 sq. ft.
Weight	68,3 lb
Dimensions	21,1 inch (W) x 21,0 inch (D) x 44,8 inch (H)

Subject to technical modifications.



Made in South Korea

Safety instructions

- If the supply cord is damaged, it must be replaced by a special cord or assembly available from the manufacturer or its service agent.
- This appliance is not intended for use by person (including children) with reduced physical sensory or mental capabilities, or lack of experience and knowledge, unless they have been given supervision or instruction concerning use of the appliance by a person responsible for their safety.
- Children should be supervised to ensure that they do not play with the appliance.
- To reduce the risk of electric shock, this equipment has a polarized plug (one blade is wider than the other). This plug will fit in a polarized outlet only one way. If the plug does not fit fully in the outlet, reverse the plug. If it still does not fit, contact qualified personnel to install the proper outlet. Do not alter the plug in any way.
- RISK OF ELECTRIC SHOCK – These servicing instructions are for use by qualified personnel only. To reduce the risk of electric shock, do not perform any servicing other than that contained in the operating instructions unless you are qualified to do so.

01.04.2016
Date

Authorized representative for technical documentation

MBM Corporation
3134 Industry Drive
North Charleston, SC 29418
800-223-2508
www.mbmcorp.com

Disposal

Pass the outdated Air Purifier onto your specialized retailer for professional disposal. You can find out about further disposal possibilities from your municipality.

Spare parts and accessories



You can purchase spare parts from specialized retailers. Only original parts from the manufacturer can be used.

Repairs

All further repairs may only be carried out from professionals or the service department. This also applies to a faulty power cord. Through improper repairs, considerable danger for the operator can result and warranty claims lapse.

Guarantee agreements

Thank you for choosing an IDEAL device.

IDEAL grants a guarantee on its products. Warranty stipulations are determined by our national representation.

- If defects due to faulty materials and workmanship occur within this guarantee period, IDEAL will repair or replace the device at its expense.
- IDEAL will only repair or replace the device, if convincing proof is provided, for example by a receipt and if the claim is made within the guarantee period.
- The guarantee is not given on wearing parts or service parts like filter.
- The guarantee is not valid if the device was not set up, run and serviced right (as according to the devices manual)
- The guarantee is not valid if filters haven't been replaced regularly with original IDEAL filters according to the description in the manual and/or the indication on the device itself.
- The guarantee is not valid if the device was connected to a power supply not matching the rating label on the machine.

For fresh air.

For more health, vitality and
quality of life. Perceptible.
With every breathe you take.

• MBM Corporation • North Charleston • South Carolina • www.mbmcorp.com •